

NOTES:

PAYNTER DIXON IS THE OWNER OF THE COPYRIGHT SUBSISTING IN THESE DRAWINGS & SPECIFICATIONS WHICH MUST NOT BE REPRODUCED OR COPIED WITHOUT THEIR WRITTEN CONSENT.

DO NOT SCALE DRAWING. VERIFY ALL DIMENSIONS ON THE SITE BEFORE COMMENCING ANY WORK OR PRODUCING ANY SHOP DRAWINGS. SHOP DRAWINGS MUST BE SUBMITTED AND APPROVED BEFORE MANUFACTURE. ALL WORK IS TO BE CARRIED OUT IN ACCORDANCE WITH THE BUILDING CODE OF AUSTRALIA AND ALL CURRENT AND RELEVANT AUSTRALIAN STANDARDS.

N

LEGEND - GENERAL

TREES TO BE DEMOLISHED

EXISTING TREES RETAIN

PROPOSED TREES

STAGING LEGEND		BUILDINGS
STAGE 1	A,B,C	
STAGE 2	D,E,F,R	
STAGE 3	G,H,J	
STAGE 4	K,L,M	
STAGE 5	N,P,Q	

F	ADDED VEGETATED RIPARIAN ZONE	15/04/13
E	LANDSCAPE AMENDMENTS	06/02/13
D	TURNING CIRCLE AMENDMENTS	25/01/13
C	ACCESS ROAD MODIFIED EVENT PARKING RELOCATED	23/01/13
B	DEVELOPMENT APPLICATION	29/10/12
A	ISSUE FOR INFORMATION	10/10/12
ISSUE	AMENDMENT	DATE

PAYNTER DIXON

Paynter Dixon Construction Pty Limited
Level 2, 2 Richardson Place
Riverside Corporate Park
North Hyde SYDNEY NSW 2113
Tel (02) 8797 5555 Fax (02) 8797 5533
Admin 04 017 123 315

CLIENT
CATHOLIC SCHOOLS OFFICE
DIOCESE OF BROKEN BAY

PROJECT
LAKE MUNMORAH CATHOLIC HIGH SCHOOL
48 - 54 CARTERS ROAD, LAKE MUNMORAH

TITLE
STAGING PLAN

SCALE 1:500 @ B1	CHECKED MG
DRAWN MK	APPROVED
PLANT DATE 15/04/2013	
PROJECT No DBB 2301	DRAWING No A004
	ISSUE F

© PPD and CASH Ltd. Project: DBB2301/12 Design: Office of Finance/TOC/ADMIN/04/12 STAGING PLAN/DBB2301.dwg

Tree Protection & Removal Legend

- Existing Tree Retained
- Existing Tree Removed
(Note: no TPZ's shown for these trees)
- Proposed Tree Protection Zone - consolidated area and temporary fencing
- Loss of roots due to excavation
- Surface impact to be managed - minimal root loss expected
- Nominal Tree Protection Zone Radius (TPZ)
- Nominal Structural Root Zone (SRZ) shown where relevant
- Tree Identification Number
- Approximate extent of EEC
- Proposed Future Building
- Existing building to be demolished
- Existing fencing

NOTES:

1. Refer to the accompanying Arboricultural Impact Assessment Report for full description of trees, measurements and methods used to assess the trees. Also provides details of proposed tree protection measures.

2. All trees outside of the extent of works shall be retained and protected. Seek advice from the nominated, superintendent and/or the Consulting Arborist for all works or access requirements that may impact on trees outside of the extent of works illustrated on this plan.

www.dialbeforeyoudig.com.au



C	Updated for Minor Site Planning Amend	RWS	29/05/13
B	Minor Site Planning Amendments	RWS	05/02/13
A	For Development Application	RWS	29/10/12
REVISION	DESCRIPTION	CHD	DATE

PROJECT & CLIENT
Lake Munmorah Catholic High School

Catholic Diocese of Broken Bay

DRAWING TITLE
Tree Protection and Removal Plan

Project No : 12.21
Designed : RWS/D50
Drawn : RWS/D50
Scale : 1:500@A1, 1:1000@A3

DRAWING NUMBER
T-02

Printed at: 11:12 AM 29/04/13

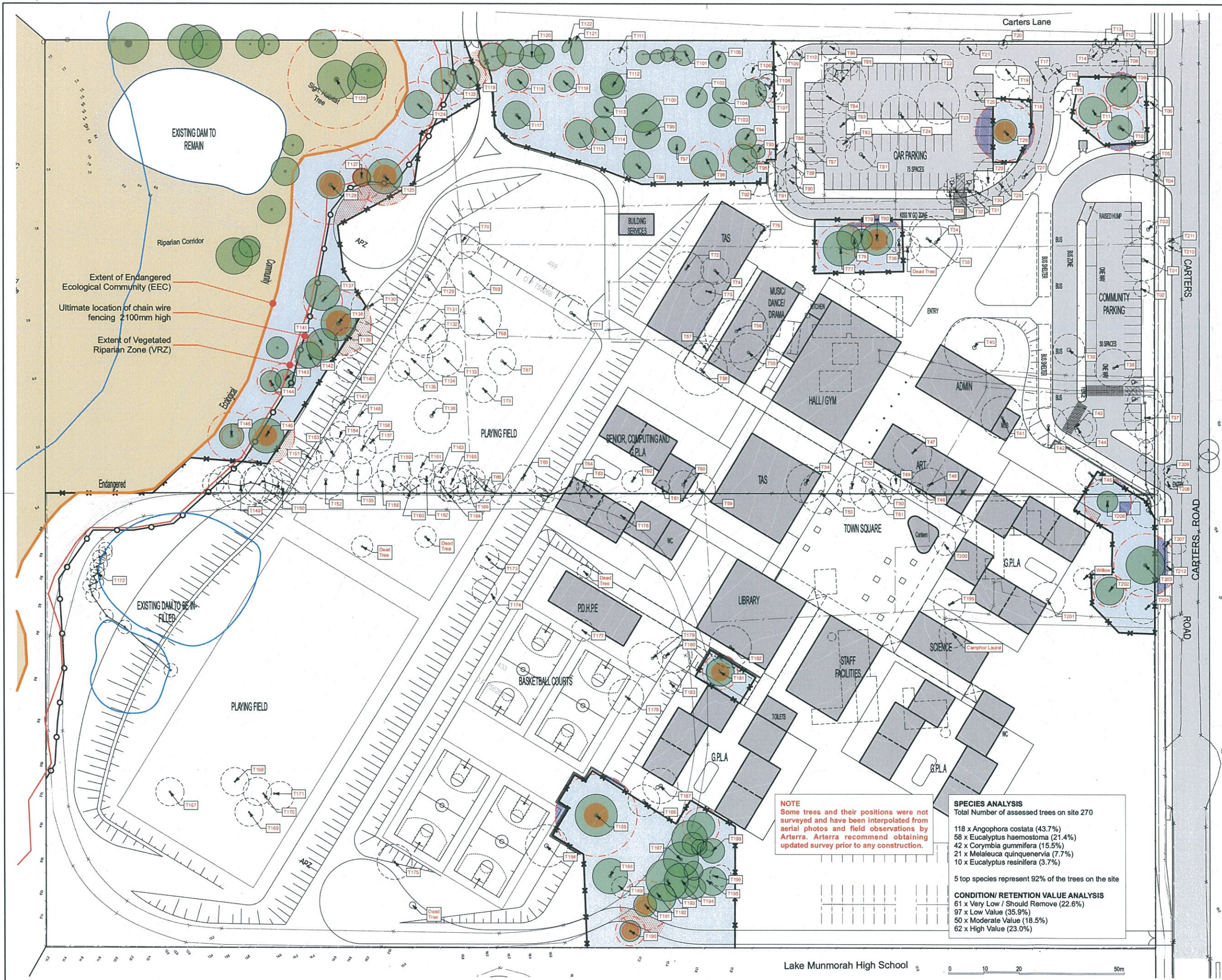

NOTE
Some trees and their positions were not surveyed and have been interpolated from aerial photos and field observations by Arterra. Arterra recommend obtaining updated survey prior to any construction.

SPECIES ANALYSIS
Total Number of assessed trees on site 270

118 x Angophora costata (43.7%)
58 x Eucalyptus haemostoma (21.4%)
42 x Corymbia gummifera (15.5%)
21 x Melaleuca quinquenervia (7.7%)
10 x Eucalyptus resinifera (3.7%)

5 top species represent 92% of the trees on the site

CONDITION/RETENTION VALUE ANALYSIS
61 x Very Low / Should Remove (22.6%)
97 x Low Value (35.9%)
50 x Moderate Value (18.5%)
62 x High Value (23.0%)

Lake Munmorah High School

